

## Technical Specifications

Materials	Mild Steel.
Connections	½" flow and return.
Test pressure	6 Bar
Testing authority	EN442
Maximum operating pressure	4 Bar
Maximum working temperature	95°C
Packaging	Wrapped in polyethylene within cardboard box.

Steel products can be cleaned using a soft damp cloth with a non abrasive cleaning product.

**PLEASE NOTE:** Systems using micro bore pipework must have adequate pressure and flow rates for the number and style of radiators on the system.

## Terms & Conditions

All products must be inspected once removed from the packaging and The Radiator Company notified within 28 days of delivery of any scratches, blemishes or other damage. The Radiator Company will then replace the radiator.

Imperfect radiators should therefore not be fitted and The Radiator Company will not accept responsibility for replacement of scratched or damaged radiators once they have been fitted. This includes any consequential loss or cost of fitting.

If The Radiator Company are not notified within 28 days of the date on the signed delivery note then it will be deemed that The Radiator Company have fully complied with its obligations and claims will not be considered.

Failure to comply with any of the above may invalidate any claims.

We recommend that after you check the product on delivery that it is stored in its packaging to prevent damage prior to installation. The Radiator Company cannot accept responsibility for items damaged after delivery.

## Guarantees & Liabilities

This product is guaranteed for 10 years. The guarantee is subject to the product being installed in accordance with British and or European standards as well as these fitting instructions. The guarantee in all cases are restricted to the free of charge replacement or repair of the failed product only. Our liability will under no circumstances extend beyond the repair or replacement of the product supplied by us. Claims for either labour in replacement or damage to property are not admissible. Any goods that are returned, in the event of a problem, will belong to The Radiator Company.

## Fittings Instructions



The elegant oval tubes 25mm x 50mm create strong lines and a pleasing aesthetic.

Please read these instructions and terms and conditions carefully prior to installation. Failure to do so may invalidate the warranty

The Radiator Company  
Units 13 - 14 Charlwoods Road  
East Grinstead  
West Sussex  
RH19 2HU

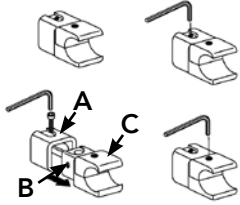


cod.1002M1117

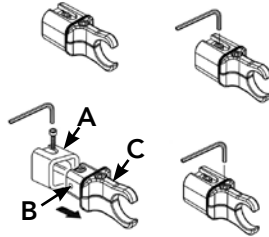
## Diagrams of Ellipsis Horizontal

**Fig 1**

Single Ellipsis

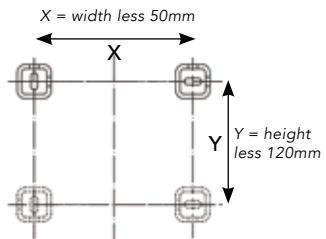


Double Ellipsis

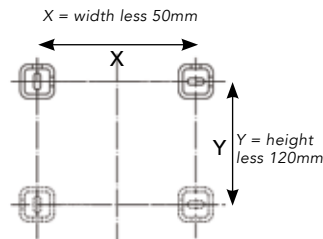


**Fig 2**

Single Ellipsis

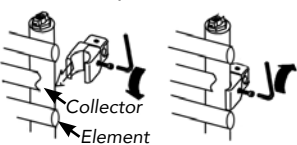


Double Ellipsis

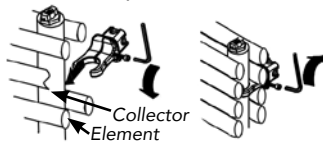


**Fig 3**

Single Ellipsis



Double Ellipsis



## Pipe Centres

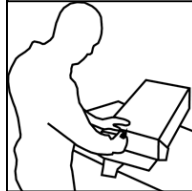
Pipe centres left to right = width of radiator - 50mm

Pipe centres from wall = *Single*: 55mm  
*Double*: 80mm - 90mm

Depth from wall = *Single*: 95mm  
*Double*: 120mm - 130mm

## 1 Unpack & Inspect

The Radiator Company prides itself on selecting products from manufacturers who exercise tight quality control measures. We only select models with excellent standards of welding and brazing, as well as high quality finishes. All of our products are well packaged and should reach you in perfect condition. Just in case however, we offer a minimum 5-year no quibble guarantee for all radiators and towel rails.



Please carefully unpack and inspect this radiator and all fittings. The Radiator Company must be notified of any shortages or damage within 28 days of delivery. For further information please see terms and conditions on back page.

## 2 Contents

You should have:

- 1 Radiator
- 4 Wall Brackets
- 4 Wall Plugs
- 4 Screws
- 4 Wall Sleeves
- 1 Airvent
- 1 Cover for Blanking Plug

You will need:

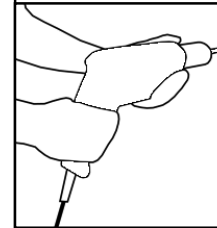
- Tape measure
- Electric drill and bits
- 1 x 5mm Hex key
- 1 x 8mm Hex key
- Screwdriver
- Spirit level

## 3 Mark Bracket Positions

1. Mark bracket positions as per *Fig. 2*, measure the width (X) of the radiator less 50mm and the height (Y) of the radiator less 120mm to find your four fixing positions for the Wall sleeves.
2. The Wall Sleeve (A in *Fig. 1*) screws into the wall in the positions as described above.
3. Attach clamps B & C to collector, between the 2nd and 3rd element above and below do' not overtighten (*Fig. 1*) this, to allow slight adjustment for inserting into wall sleeves.
5. Raise radiator and slot into Wall sleeves" A" and tighten (*Fig. 3*).

## 4 Fix Brackets

Using a suitable drill bit, screws and plugs, fix the brackets and level with a spirit level (please see diagrams).



### PLEASE NOTE :

It is essential that all brackets are level to ensure a vertical alignment for connecting the pipework.

## 5 Hang Radiator & Commission

With the brackets sleeves firmly fixed and level, the radiator can be hung in position by inserting the brackets into the sleeves and securing with the grub screws provided.

### Please Note:

In accordance with Part L1 2006 of the Building Regulations and BS7593:1992 code of practice for the treatment of hot water and central heating systems, we strongly recommend flushing the heating system post installation of new radiators and then adding the correct quantity and type of inhibitor for use with your radiator and system to prevent corrosion. Damage caused to systems not protected by a suitable inhibitor will not be covered by manufacturer's guarantee.